



# LOVE LIVING

HACKNEY



269 Corfield Street, London, E2 0DU

£2,300





£2,300

# 269 Corfield Street

London, E2 0DU

- Modern finishes
- Close to Victoria Park and Brick Lane
- Balcony access
- Herringbone flooring
- Prime location
- Five minute walk to Bethnal Green underground

## The Home –

This beautifully designed home offers modern elegance and practical living, with bright, airy spaces and thoughtful details throughout. Featuring a stylish and bright living room, a sleek, well-equipped kitchen with balcony access, and a tranquil bedroom retreat with an en-suite, this home is crafted for comfort and convenience. With ample natural light, contemporary finishes, and smart storage solutions, it provides a warm and inviting atmosphere. Corfield street offers a rich mix of traditional pubs, independent cafes, and renowned restaurants like Brawn, Redchurch Brewery, and Sager + Wilde, while nearby Broadway Market, Victoria Park, Columbia Road Flower Market, and Regent's Canal provide great weekend strolls. Art lovers will appreciate the proximity to galleries such as Maureen Paley, Modern Art, and Herald St. Bethnal Green Overground is just a few minutes away, with the Underground's Central Line and Whitechapel's Elizabeth Line connections also within easy reach. With excellent transport links, a thriving creative scene, and some of London's best markets, shops, and nightlife close by, this home offers both comfort and convenience in a dynamic setting.



## The Indoors

You are welcomed into a bright and inviting hallway that effortlessly connects all areas of the home. To your right, the main living space unfolds a beautifully styled room filled with natural light streaming through elegantly placed windows. The space feels open and airy, offering the perfect setup for a cosy sofa and TV area while maintaining a sense of calm with its neutral tones and soft textures.

To the left, the kitchen is a mix of modern functionality and stylish design. The sleek tiled flooring guides you through a space that offers ample room for a dining setup, making it ideal for both quiet mornings and lively dinner gatherings. The fitted oven, gas hob, and fridge freezer are seamlessly integrated, while the wooden countertops add warmth. Generous storage ensures that every kitchen essential has its place. The added door leading out to a private balcony makes it perfect for a morning coffee or evening unwind.

Moving ahead, the bedroom is a peaceful retreat, bathed in natural light from the generously sized windows. There's ample space for a double bed, and the fitted wardrobes provide great storage without compromising the room's spacious feel. The en-suite shower room is nothing short of stylish, featuring a unique tiled backdrop, a sleek glass walk-in shower with a luxurious rainfall shower head, and contemporary fixtures that create a spa-like ambiance.

Adjacent to the bedroom, you'll find a separate W/C which is bright, clean, and efficiently designed with a window for natural ventilation. Every fixture and fitting has been chosen with both style and practicality in mind.

## The Outdoors





This cosy urban balcony is the perfect little escape from the bustle of city life. With warm sunlight streaming in, a charming bistro set invites you to sip your morning coffee or enjoy an evening breeze. The string lights along the railing hint at cosy nights, while the rustic wooden shelving adds a touch of practicality and style. Positioned between brick and modern facades, this space is a peaceful retreat with just the right balance of charm and function.

### Loving The Location

Bethnal Green is one of the most established east London neighbourhoods. The area has an exciting mix of traditional pubs and cafes, such as E Pellicci, Breid Bakers, the famous Tayyabs in Whitechapel and The Approach Tavern, as well as a new wave of bars and restaurants, including Brawn, Redchurch Brewery and Sager + Wilde on Paradise Row. Common E2 is just around the corner for coffee. The area is home to many design and architecture practices as well as great small commercial galleries, including Maureen Paley, Modern Art, and Herald St. Brick Lane, Shoreditch and Hackney are all close by offering some of London's most famous cafes, restaurants, shops, markets and nightlife options.

Broadway Market and Columbia Road Flower Market are within easy walking distance of Wilmot Street, while an enjoyable walk along Regent's Canal leads to Victoria Park and Haggerston Park. The V&A Museum of Childhood is very close by, as is York Hall Leisure Centre. Corfield Street is located within four minute walk from Bethnal Green overground station. Bethnal Green underground station gives access to the Central line and is five minute walk away, whilst Whitechapel station is a short walk giving access to the new Elizabeth line. There are excellent bus links to Hackney, central London and beyond.





## Floor Plans

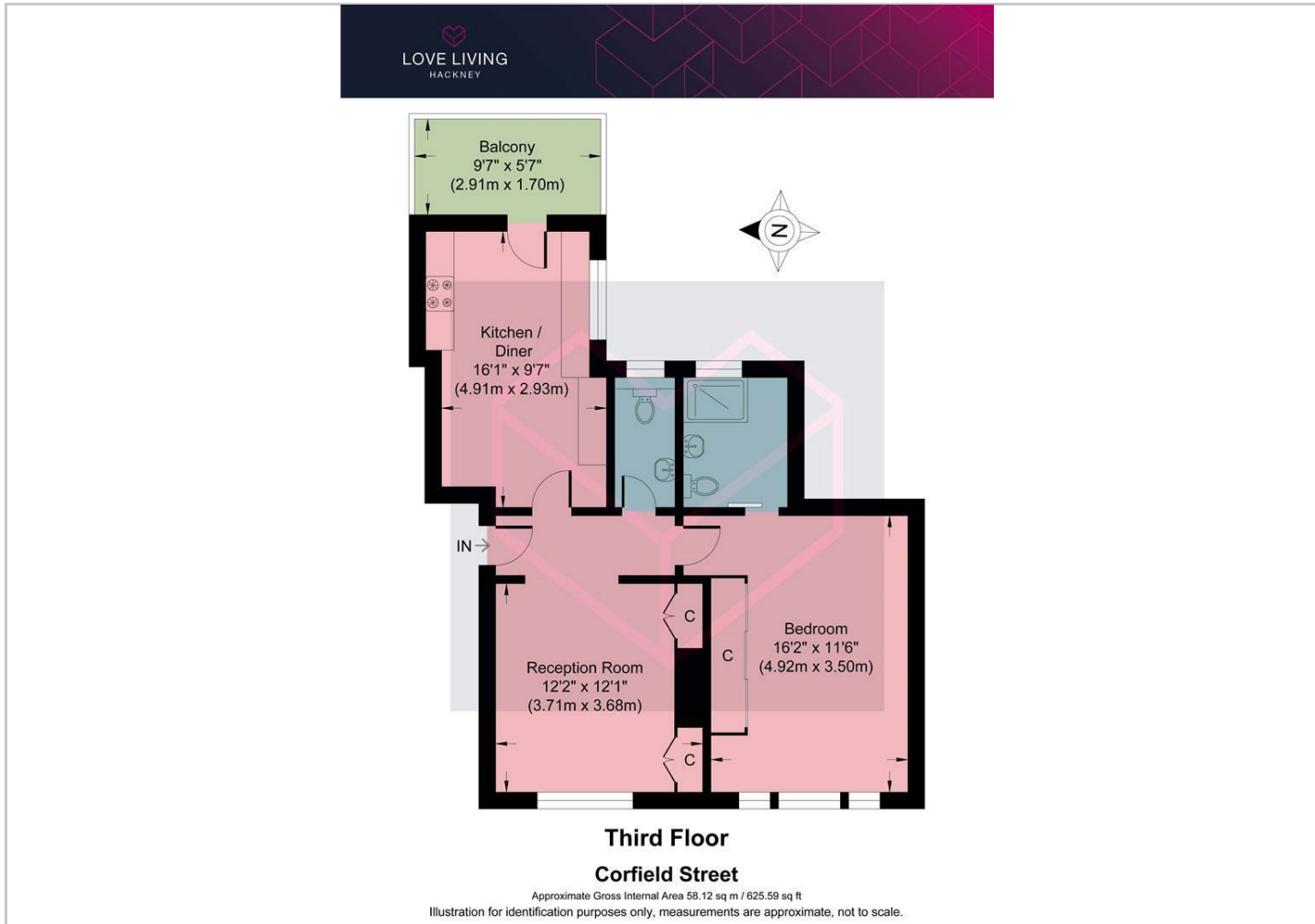

## Viewing

Please contact our Love Living Hackney Office on 0203 005 2600 if you wish to arrange a viewing appointment for this property or require further information.

The particulars are set out as a general outline only for the guidance of intended purchasers or lessees, and do not constitute, any part of a contract. Nothing in these particulars shall be deemed to be a statement that the property is in good structural condition or otherwise nor that any of the services, appliances, equipment or facilities are in good working order. Purchasers should satisfy themselves of this prior to purchasing.

Studio 74, Containerville 1 Emma Street, London, E2 9DT  
 Tel: 0203 005 2600 Email: [hello@loveliving.uk](mailto:hello@loveliving.uk) <https://www.loveliving.uk>

## Location Map

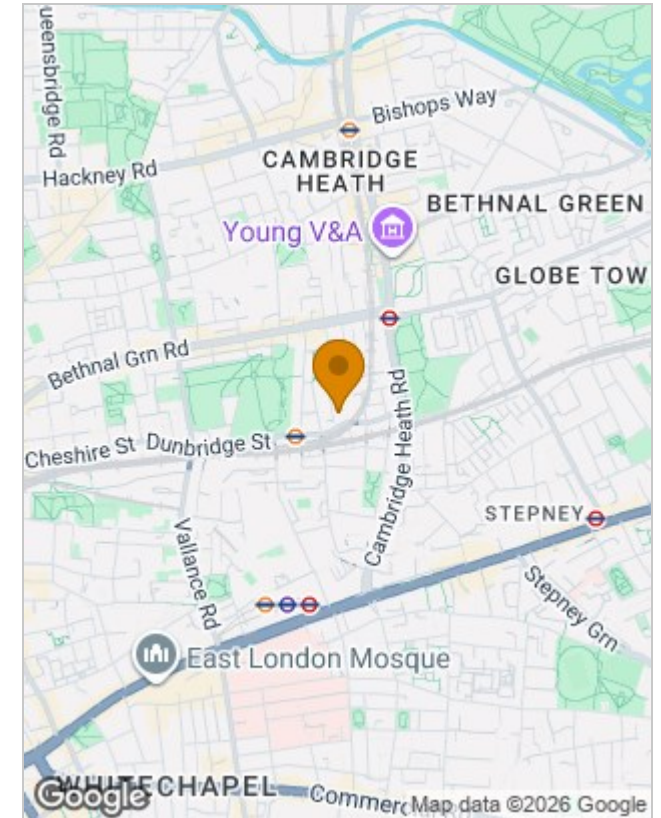

## Energy Performance Graph

